

HAYES

REPAIRS | SALES | TRAINING

Simple Maintenance Procedures

Extend the Life of Your Handpieces

OneStep[™] Handpiece Lubricant

- Longer turbine life!
- Available in aerosol, dropper bottle or bottle for automatic lubrication station
- Nozzle adapters to fit any high-speed!

Ask us about Handpiece Maintenance Systems



Tidy Whities

Original Handpiece & Instrument Wipes



- Cleans & shines
- Convenient
- Non-corrosive

Treat Your Waterlines!



- Remove microbial contamination from waterlines and bottles
- Protect staff, patients, and handpieces!

Need Staff Training?

- 1 FREE CE credit per course!

Between-Patient Manual Maintenance for

HIGH-SPEED HANDPIECES

1

Clean and lubricate

Remove debris from the handpiece using alcohol and 2" x 2" gauze, or wipe with a Tidy Whities[™] original handpiece & instrument wipe before lubricating. You may also use soap and water to clean a handpiece, however, avoid allowing soap and water to enter the head of the handpiece. (Do not wipe a handpiece down with cleaning/disinfecting wipes or other harsh chemicals.)



AEROSOL INSTRUCTIONS:

- Remove bur
- Select the appropriate nozzle and insert into swivel back-end or back of 4/5-hole handpiece. Selecting the proper nozzle will ensure a tight seal to propel lubricant throughout the handpiece.
- Spray one second when using Hayes OneStep aerosol (Refer to manufacturer instructions for J. Morita high-speeds)
- Clean chuck weekly with lube and proxy brush

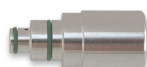

Star



NSK



W&H/Adco less bulb



Kavo



Midwest XGT/Stylus/Bien-Air



E-Type attach



5-Hole



3-Hole

2

Run the handpiece on a flush station

Run for 20 seconds. Handpieces requiring a bur tool must be run with the bur installed. If flush station is not installed, run handpiece chairside. Wipe handpiece exterior with paper towel.



We sell the DCI Flush Station! Call Hayes for more information.

3

Bag and sterilize

Always let the handpieces go through the complete drying cycle (*never use dry heat*). Handpieces are ready to use and **DO NOT NEED TO BE RELUBRICATED**. Never sterilize with a bur installed.

Between-Patient/Weekly Manual Maintenance for

LOW-SPEEDS, ATTACHMENTS & SCALERS

1

Clean and lubricate

Place 1-3 drops from the dropper bottle at all points as indicated below. For motors, attachments and heads, lubricate at least twice a week or as specified by the manufacturer. Clean threads monthly with alcohol and 2" x 2" gauze or Tidy Whities wipes.



LOW-SPEED MOTORS & AIR SCALERS

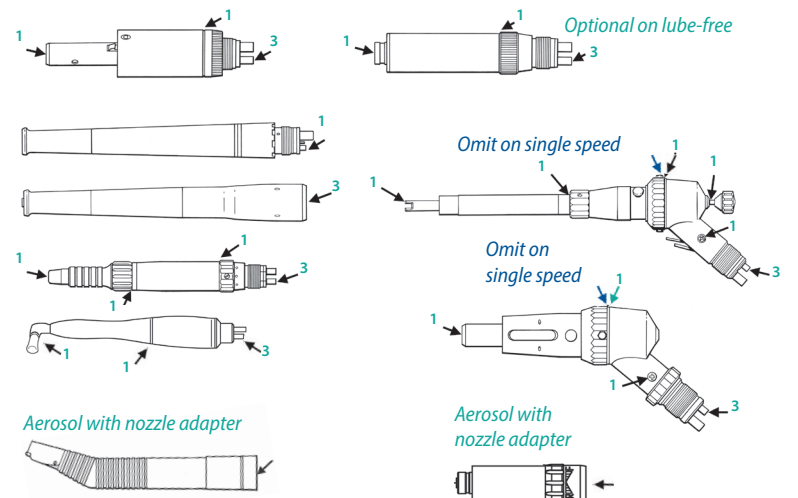

LOW-SPEED ATTACHMENTS & HEADS

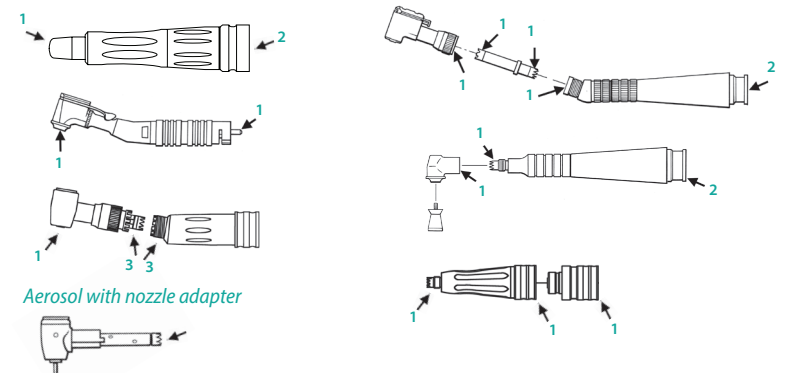

ELECTRIC, ENDO & IMPLANT HANDPIECES

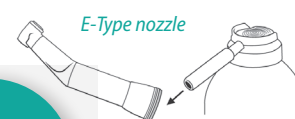

Lubricating and flushing electric handpieces between patients is crucial. However, never lubricate an electric motor. Please consult your Hayes office for detailed instructions.

2

Run the handpiece

Run for 20 seconds. Wipe handpiece exterior with paper towel.

3

Bag and sterilize

Always let the handpieces go through the complete drying cycle (*never use dry heat*). Handpieces are ready to use and **DO NOT NEED TO BE RELUBRICATED**. Never sterilize with a bur installed.

HAYES

REPAIRS | SALES | TRAINING

www.hayeshandpiece.com

Call us to purchase maintenance products or to schedule staff training!

Bien Air

LABS

FACTORY-TRAINED

LABS

MIDWEST

StarDental